

# Bienvenue@tribu.paris

Rejoignez tribu.paris ! Et profitez d'un nouveau lieu conçu pour réinventer la vie active ensemble.

# tribu

Paris



# Étage courant

du R+1 au R+4

1 148 m<sup>2</sup>

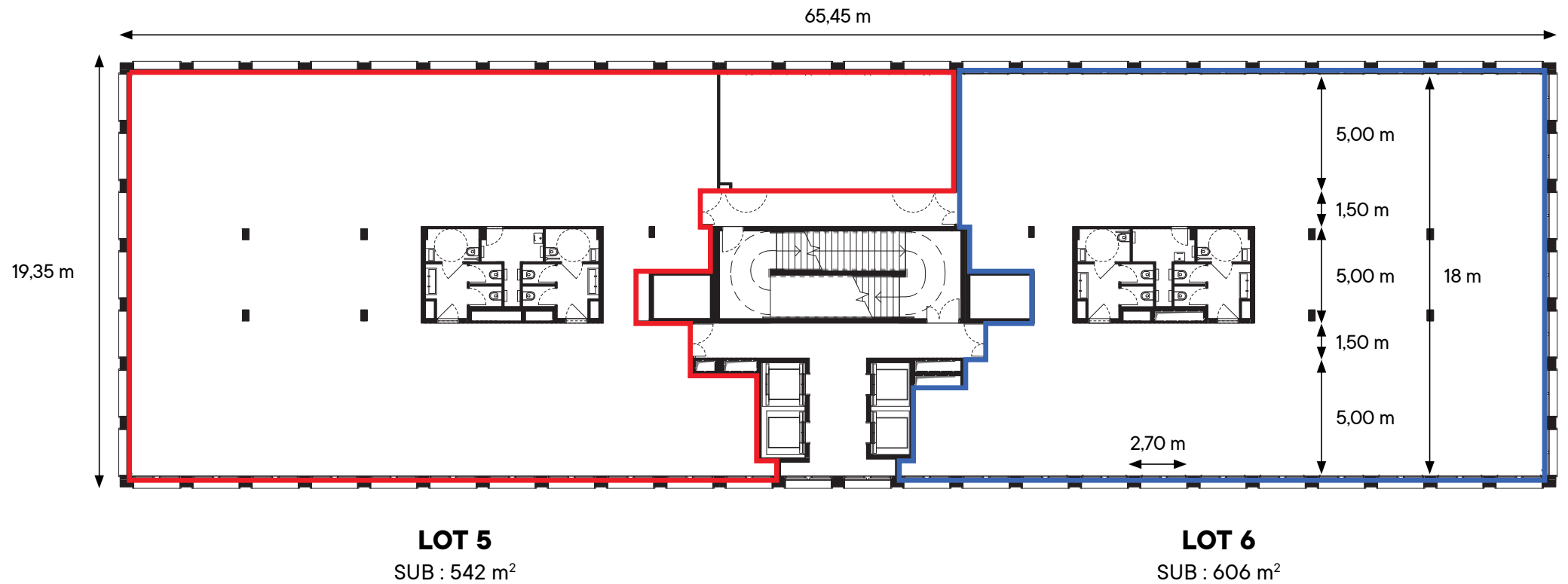







# R+2

# 1 148 m<sup>2</sup>

## Simulation d'aménagement traditionnel

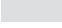
**Capacitaire 110 personnes**  
**Nombre de postes de travail**  
103 postes

-  Bureaux cloisonnés ou open space
-  Salles de Réunion
-  Espaces de convivialité / Tisanerie
-  Palier
-  Sanitaires
-  Ascenseur / Escalier

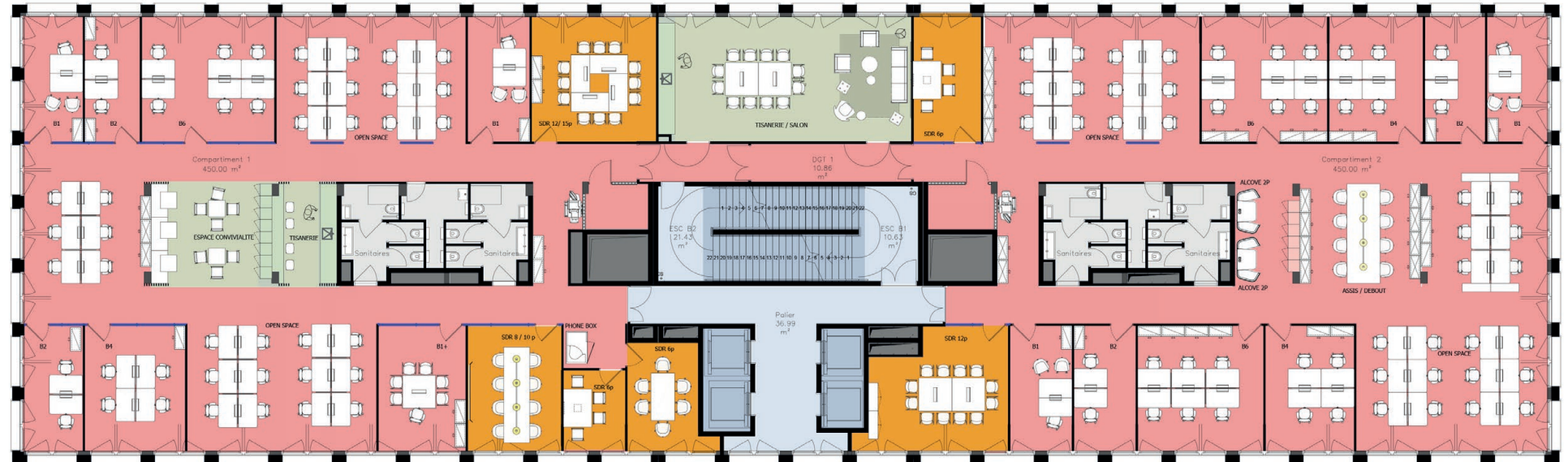







# R+2

# 1 148 m<sup>2</sup>

## Simulation d'aménagement collaboratif

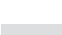

**Capacitaire 110 personnes**  
**Nombre de postes de travail**  
100 postes

-  Bureaux cloisonnés ou open space
-  Salles de Réunion
-  Open meeting
-  Espaces de convivialité / Tisanerie
-  Palier
-  Sanitaires
-  Ascenseur / Escalier

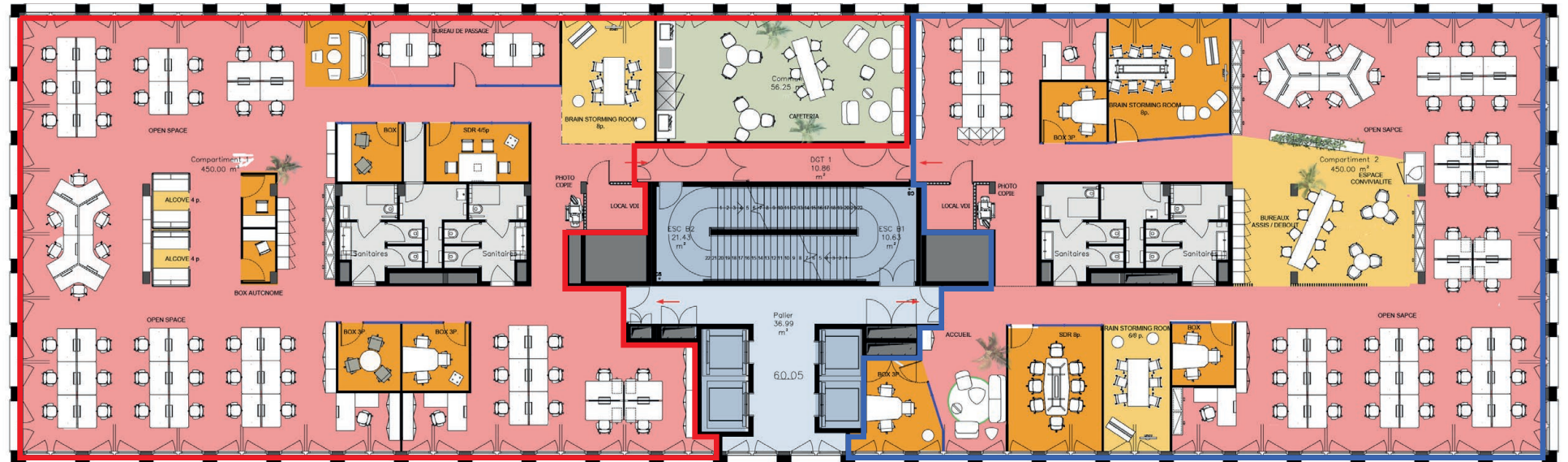

**LOT 5**  
SUB : 542 m<sup>2</sup>

**LOT 6**  
SUB : 606 m<sup>2</sup>





**Un projet Stam Europe**



**tribu** Paris



**Rejoignez-nous sur [tribu-paris.fr](http://tribu-paris.fr) !**